

Original BMW Accessories. Installation Instructions.



Retrofit - BMW Performance Gearshift Kinematics BMW 3 Series (E90, E91, E92, E93) BMW 1 Series (E81, E82, E87, E88)

Installation instructions applicable only to vehicles with 6-cylinder petrol engine.

Retrofit kit No.	25 11 0 430 357	Retrofit, gearshift kinematics (330i - LHD)
	25 11 0 430 359	Retrofit, gearshift kinematics (328i - LHD)
	25 11 0 430 360	Retrofit, gearshift kinematics (335i - LHD)
	25 11 0 444 655	Retrofit, gearshift kinematics (128i - LHD)
	25 11 0 444 656	Retrofit, gearshift kinematics (130i - LHD)
	25 11 0 444 657	Retrofit, gearshift kinematics (135i - LHD)
	25 11 0 444 658	Retrofit, gearshift kinematics (330i - RHD)
	25 11 0 444 659	Retrofit, gearshift kinematics (335i - RHD)
	25 11 0 444 660	Retrofit, gearshift kinematics (130i - RHD)
	25 11 0 444 661	Retrofit, gearshift kinematics (135i - RHD)

Installation time

The installation time of **approx. 1.0 hour** may vary depending on the vehicle's condition and equipment.

The vehicle must be updated to the latest I-level status by flashing before installing the retrofit. Different programming times are necessary depending on the production age of the vehicle and the work already performed on the vehicle so that no time requirements can be specified here. The installation time does not include the time required for programming/encoding which depends on the vehicle's age and equipment.

Important information

These installation instructions are primarily designed for use within the BMW dealership organisation and by authorised BMW service companies.

In any event, the target group for these installation instructions is specialist personnel trained on BMW cars with the appropriate specialist knowledge.

All work must be completed using the latest BMW repair manuals, circuit diagrams, servicing manuals and work instructions, in a rational order, using the specified tools (special tools) and observing current health and safety regulations.

In the event of installation or functional problems, limit troubleshooting to 0.5 hours for mechanical jobs.

To avoid unnecessary work and costs, send a corresponding enquiry via the Aftersales Assistance Portal (ASAP) using the technical parts support application.

Please quote the following:

- Vehicle identification number
- Part number of retrofit kit
- Exact description of the problem
- Work already carried out.

Do not archive the hard copy of these installation instructions since daily updates are made by ASAP!

All pictures show LHD cars; proceed accordingly on RHD cars.

Pictograms



Denotes instructions that draw your attention to special features.

- ◀ Denotes the end of the instruction or other text.

Installation note

The removal and installation procedures are shown on the E46. The procedures are the same for the E90.

Special tools required

25 1 120 Pin wrench

Contents

Section	Page
1. Preparatory work	4
2. Parts overview	5
3. Removing existing gearshift lever	6
4. Installing gearshift lever (see TIS No. 25 11 000)	9
5. Concluding work and coding	12

1. Preparatory work

	TIS No.
Perform quick test	—
Disconnect negative terminal of battery	12 00 ...
Remove the following components	
Underbody panelling if necessary	—
Remove rear underside guard	51 47 491

2. Parts overview

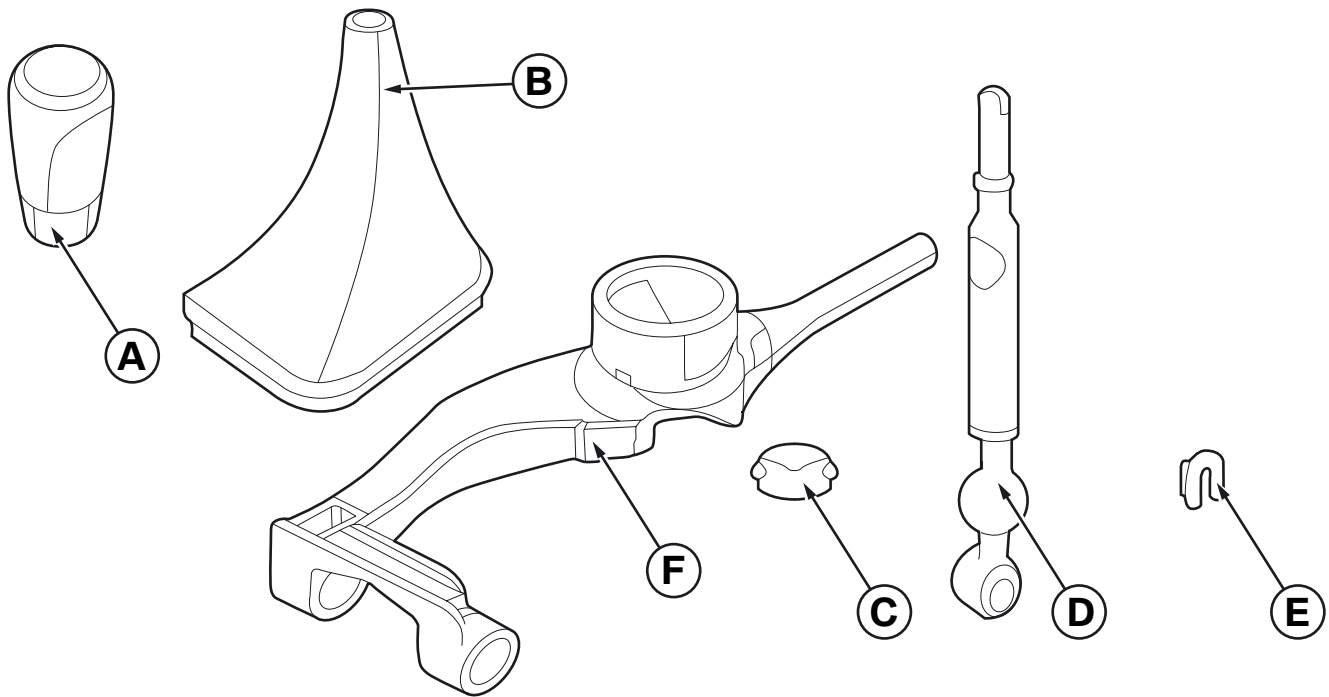

090 0390 V

Legend

- A** Gearshift knob
- B** Gaiter
- C** Gearshift lever bearing
- D** Gearshift lever (schematic representation)
- E** Retainer
- F** Selector arm (only for 135i and 335i)

3. Removing existing gearshift lever

▶ As from 03/07 there are two different versions. In version 1 the gearshift knob and the gearshift lever cover are separate. In version 2 the gearshift knob and the gearshift lever cover are one piece. ◀

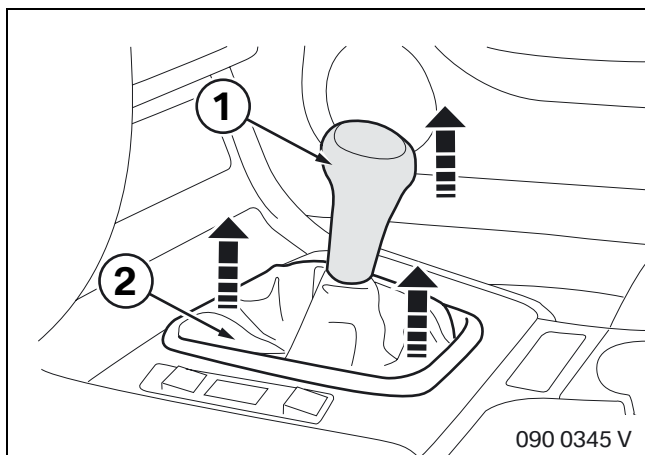

Version 1:

▶ Do not twist shift knob (1) while pulling off otherwise the lock in the knob may shear off. ◀

Pull off shift knob (1) with a sharp tug.

▶ Start removing the gaiter (2) from the left otherwise the frame may be damaged. ◀

Press together installation frame of gaiter (2) a little and remove gaiter (2) from the centre console.

See TIS No. 25 11 071.

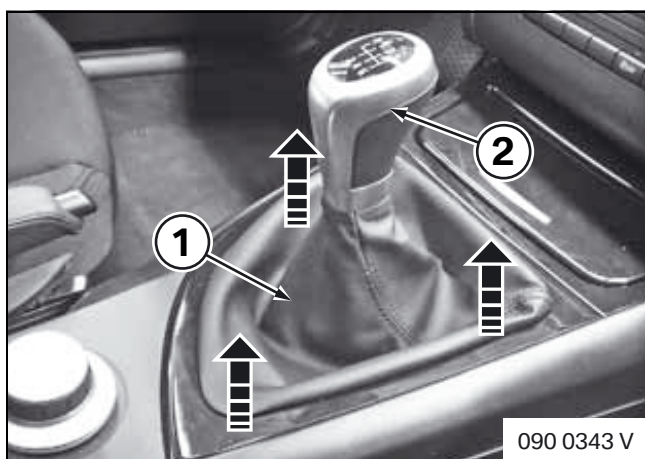

Version 2:

▶ Version 2 may be damaged if removed incorrectly.

Start removing the gaiter (1) from the left otherwise the frame may be damaged. ◀

Press together installation frame of gaiter (1) a little and remove gaiter (1) from the centre console.

▶ Do not twist shift knob (2) while pulling off otherwise the lock in the knob may shear off. ◀

With a strong tug, pull off shift knob (2) together with gaiter (1).

See TIS No. 25 11 071.

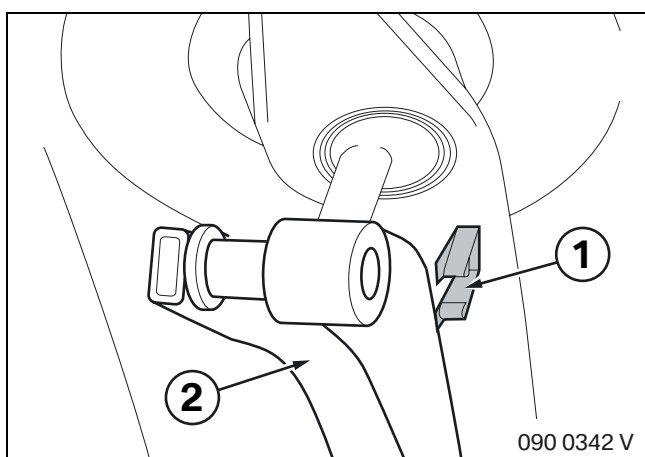

For all vehicles:

First lever out retainer (1).

Then pull out selector rod (2).

3. Removing existing gearshift lever

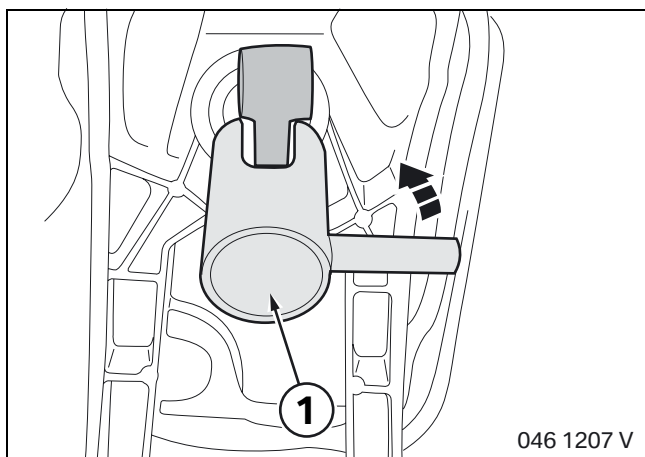

Fit special tool (1) in the bearing mount and turn through 90° in anticlockwise direction.

Press bearing mount upward out of the selector arm.

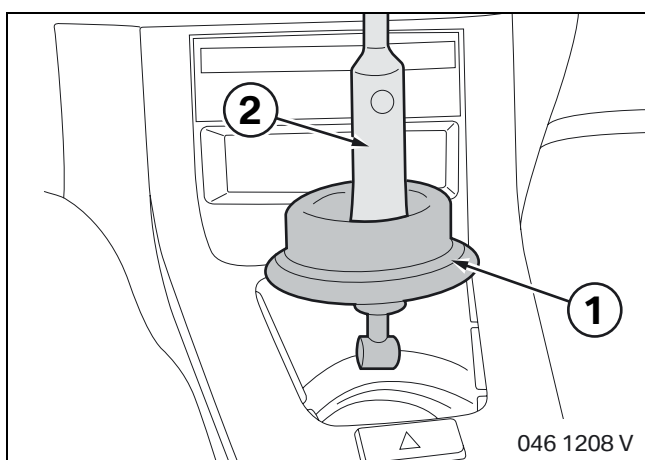

Pull rubber gaiter (1) out of cutout in body and remove by pulling upward together with the gearshift lever (2).

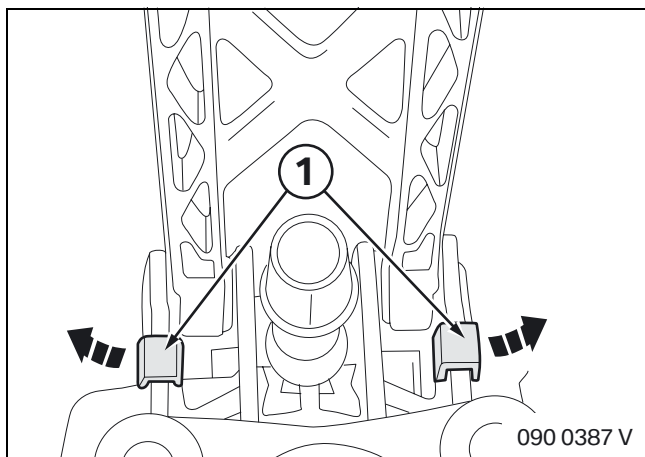

Only for vehicles 135i and 335i:

Release retainers (1) in direction indicated by arrow and remove.

See TIS No. 25 11 211.

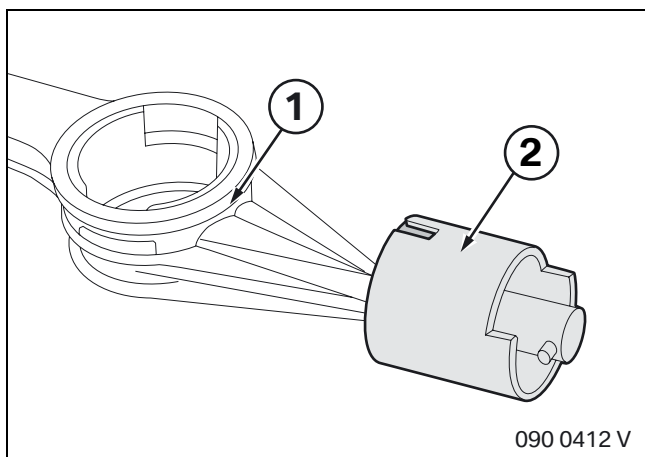

Remove selector arm (1) and detach support bearing (2) from selector arm (1).

See TIS No. 25 11 211.

3. Removing existing gearshift lever

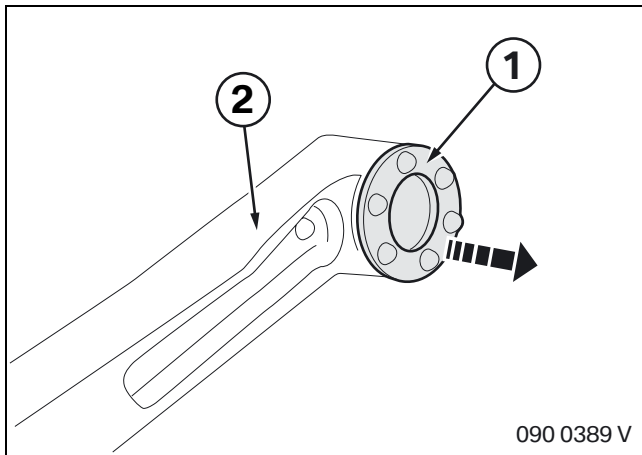

Press rubber bushes (1) out of old selector arm (2) and check for damage. If undamaged, the rubber bushes (1) can be reused during assembly of the selector arm **F**. Otherwise replace.

4. Installing gearshift lever (see TIS No. 25 11 000)

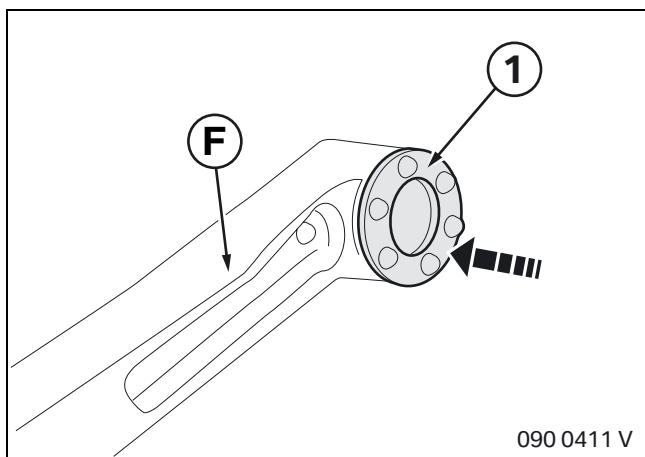

▶ For vehicles 135i and 335i - installing selector arm **F** as per TIS No. 25 11 211 and 25 11 245. ◀

▶ If damaged, replace the old rubber bushes (1).
 The old rubber bushes (1) can otherwise be reused.
 Grease rubber bushes (1) with standard BMW lubricant. ◀
 Press bearing bushes (1) into selector arm **F** until the side rims protrude evenly.

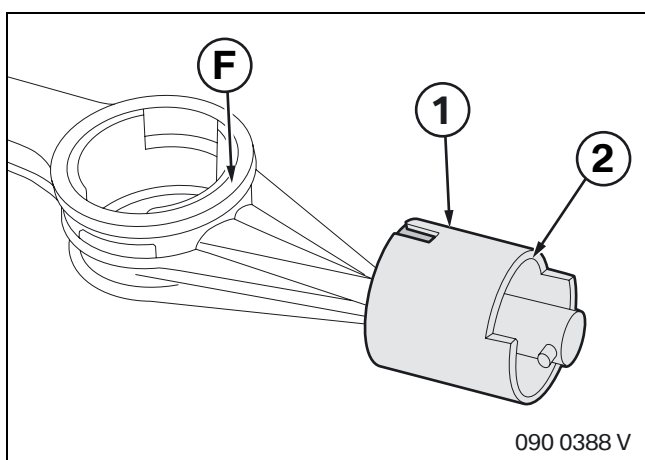

▶ Grease support bearing (1) with standard BMW lubricant. ◀

With recess (2) positioned at the rear, fit support bearing (1) on to selector arm **F**.

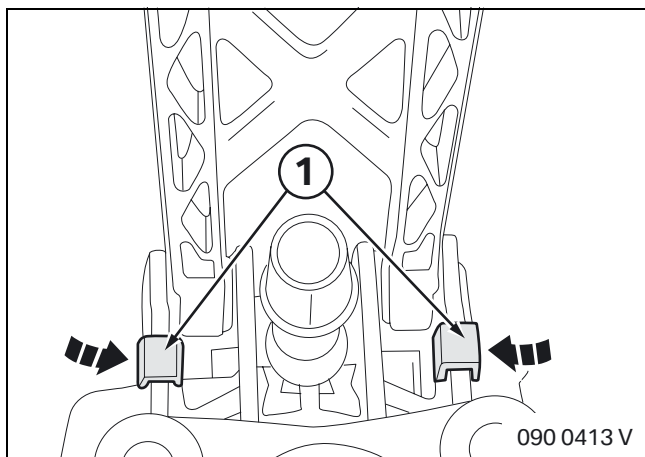

▶ Grease retainers (1) with standard BMW lubricant. ◀

Fit retainers (1) in direction indicated by arrow and lock in position.

See TIS No. 25 11 211.

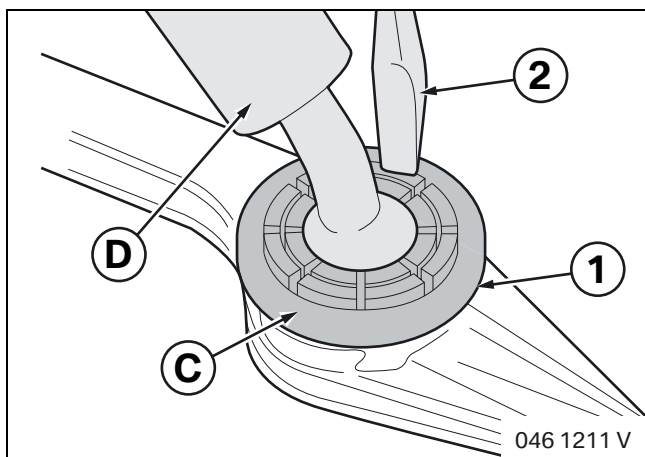

For all vehicles:

▶ Grease ball of gearshift lever with standard BMW lubricant. ◀

Fit gearshift lever **D** in selector arm (1).

Align bearing of gearshift lever **C** such that the arrows on the bearing **C** point in longitudinal direction and the retaining lugs of the gearshift lever bearing **C** are positioned in transverse direction.

Use a screwdriver to press gearshift lever bearing **C** in area of retaining lugs until the bearing **C** audibly snaps into position.

4. Installing gearshift lever (see TIS No. 25 11 000)

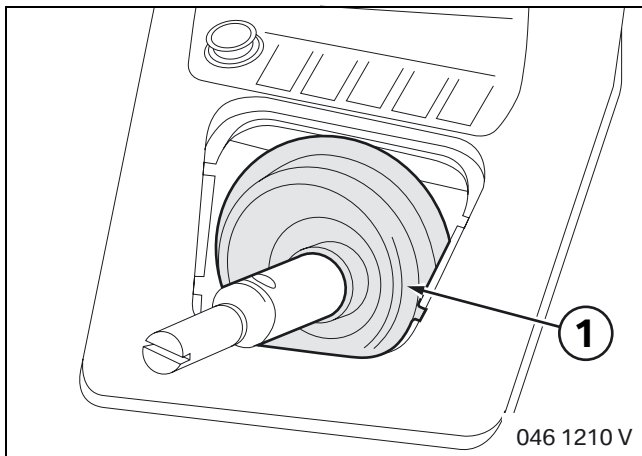

Fit rubber gaiter (1) with the arrow pointing in forward direction.

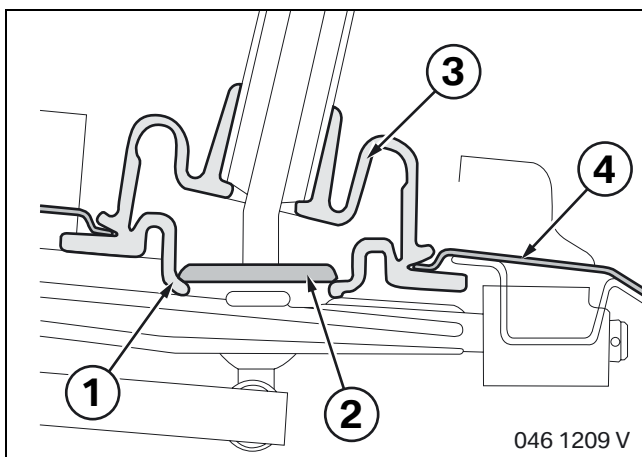

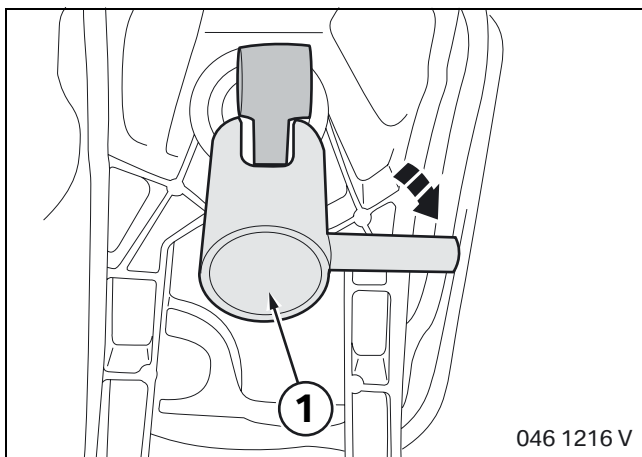

Pull inner rubber gaiter (1) over plate (2) on the selector arm and fit outer rubber gaiter (3) in body cutout (4).

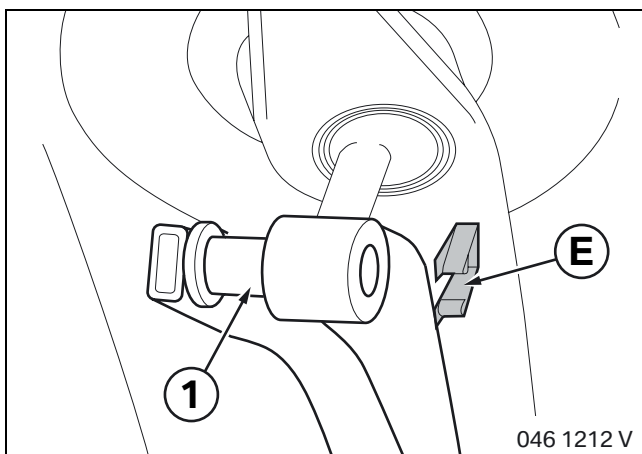

Fit the bearing mount in the selector arm.

Fit special tool (1) in the bearing mount and turn through 90° in clockwise direction.



 Grease gearshift lever pin (1) with standard BMW lubricant. ◀

Fit selector rod and retainer **E**.

4. Installing gearshift lever (see TIS No. 25 11 000)

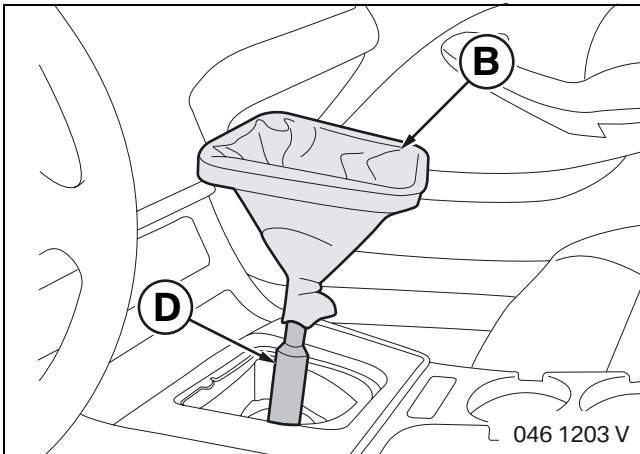

Pull down gaiter **B** and fit on gearshift lever **D**.
Secure gaiter **B** with cable strap.

Pull gaiter **B** over gearshift lever **D** and fit in the centre console.

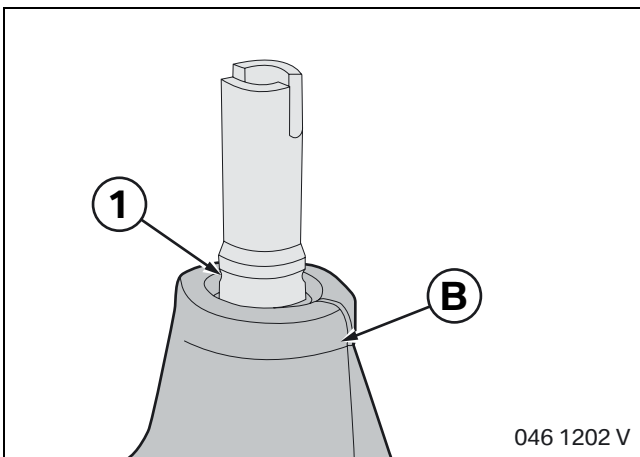

Slide gaiter **B** downward until groove (1) is completely exposed.

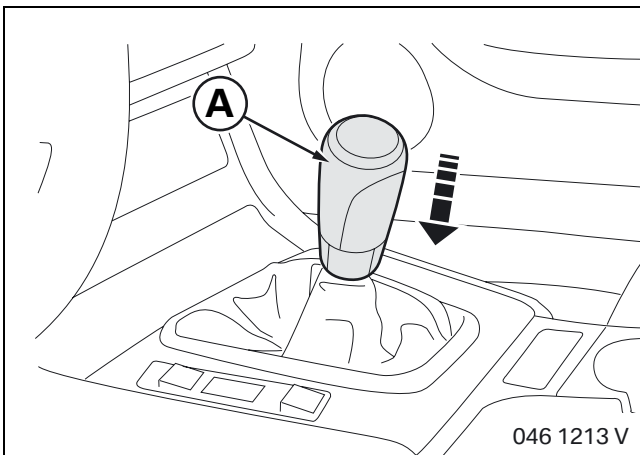

Fit shift knob **A** on gearshift lever **D**, align and press until it is felt to snap into position.

5. Concluding work and coding

The retrofit system does not require encoding.

- Reconnect vehicle battery
- Perform quick test
- Reassemble vehicle in reverse order of removal

 After assembling, check the freedom of movement of the gearshift lever in all gears. ◀