

Original BMW Accessories.

Installation Instructions.



BMW Performance sport seat retrofit

BMW 1 Series (E81, E82, E87)

BMW 3 Series (E90, E91, E92)

Retrofit kit No.	52 10 0 442 125	Sport seat retrofit kit
	52 10 0 442 126	Sport seat retrofit kit
	52 10 0 442 127	Sport seat retrofit kit
	52 10 0 442 128	Sport seat retrofit kit
	52 10 0 442 129	Sport seat retrofit kit
	52 10 0 442 130	Sport seat retrofit kit

Installation time

The installation time is **approx. 0.25 hours**. The installation time will increase by **approx. 1.0 hour** for cars with an electric or partially electric seat. This may vary depending on the condition of the car and the equipment in it.

In general the car must be upgraded to the latest I stage status by flashing before starting the work. Differing programming times may be necessary depending on the production age of the vehicle and on work previously performed on the vehicle.

The installation time given does not include time needed for programming/encoding.

The total costs for the programming time should be taken into account when calculating retrofitting costs (reimbursement through warranty is not permissible).

Important information

These installation instructions are primarily designed for use within the BMW dealership organisation and by authorised BMW service companies.

In any event, the target group for these installation instructions is specialist personnel trained on BMW cars with the appropriate specialist knowledge.

All work must be completed using the latest BMW repair manuals, circuit diagrams, servicing manuals and work instructions, in a rational order, using the prescribed tools (special tools) and observing current safety regulations.

If you experience installation or functional problems, limit troubleshooting to approx. 0.5 hours for mechanical or 1.0 hour for electrical work.

In order to reduce costs and avoid any additional expense, send a query immediately to the Technical Parts Support via the Aftersales Assistance Portal (ASAP).

Quote the following information:

- Chassis number,
- Part number of the retrofit kit,
- A precise description of the problem,
- Work steps already carried out.

Do not archive the hard copy of these installation instructions since daily updates are provided via ASAP!

Pictograms



Denotes instructions that draw your attention to dangers.



Denotes instructions that draw your attention to special features.



Denotes the end of the instruction or important text.

Installation information



The BMW Performance sport seat can be installed at a height to suit the individual customer.

Talk to the customer before installation.

For the recommended seat position, see the "To change the height setting of the BMW Performance sport seat" chapter. ◀

Ensure that the cables and/or lines are not kinked or damaged as you install them in the car. The costs incurred as a result will not be reimbursed by BMW AG.

Additional cables/lines that you install must be secured with cable ties.

If the specified PIN chambers are occupied, bridges, double crimps or twin-lead terminals must be attached.

All pictures show LHD cars; proceed accordingly on RHD cars.

After the installation work the retrofit kit must be programmed/coded via the **Retrofit/CIP** path.

Ordering instructions

The following parts are not supplied in the retrofit kit and must be ordered separately (see EPC for part number and details).

- Allen screw M8 x 16 mm **B** (part no. 07 14 7 146 686)
- Allen screw **C** (part no. 52 10 0 447 951)
- Retrofit cable **D** (only cars with an electric or partially electric seat)



Allen screws **C** are only required if the seat height is changed. ◀



Allen screws **B** and **C** are micro-encapsulated. They are only allowed to be used once. ◀

Important information for the customer

Print out the Customer information chapter at the end of the installation instructions and give it to the customer.



Retrofitting the BMW Performance sport seat deactivates the function of the seat belt reminder for the front passenger seat. In addition, the belt hand-over is deactivated in the E92.

The driver must make sure that the front-seat passenger has fastened his or her seat belt before setting off. The function of the passenger airbag is unaffected by the seat belt reminder having been switched off. ◀



Subsequent installation of BMW Performance sport seats does not invalidate the owner's manual.

The BMW Performance sport seat is included in the European type approval for the car. There is no need for the installation to be approved by a technical monitoring organisation or for an entry to be made in the registration document. ◀



In the BMW Performance sport seat with Easy-Entry system, the seat front/back adjustment of the BMW Performance sport seat can only be accomplished by operating the backrest lever. If the lever is not operated, the BMW Performance sport seat remains locked in its current front/back position. ◀

Special tools required

None

Table of contents

Section	Page
1. Parts list	4
2. Preparatory work	5
3. Connection diagram (cars with electric or partially electric seat only)	6
4. Installation and cabling diagram (cars with electric or partially electric seat only)	7
5. To route and connect the retrofit cables (cars with electric or partially electric seat only).....	8
6. To install the BMW Performance sport seat.....	11
7. To change the height setting of the BMW Performance sport seat	12
8. Concluding work and coding	13
9. Connection diagram (cars with electric or partially electric seat after 03/07 only).....	14
10. Connection diagram (cars with electric or partially electric seat before 03/07 only)	15
11. Customer information	16

1. Parts list

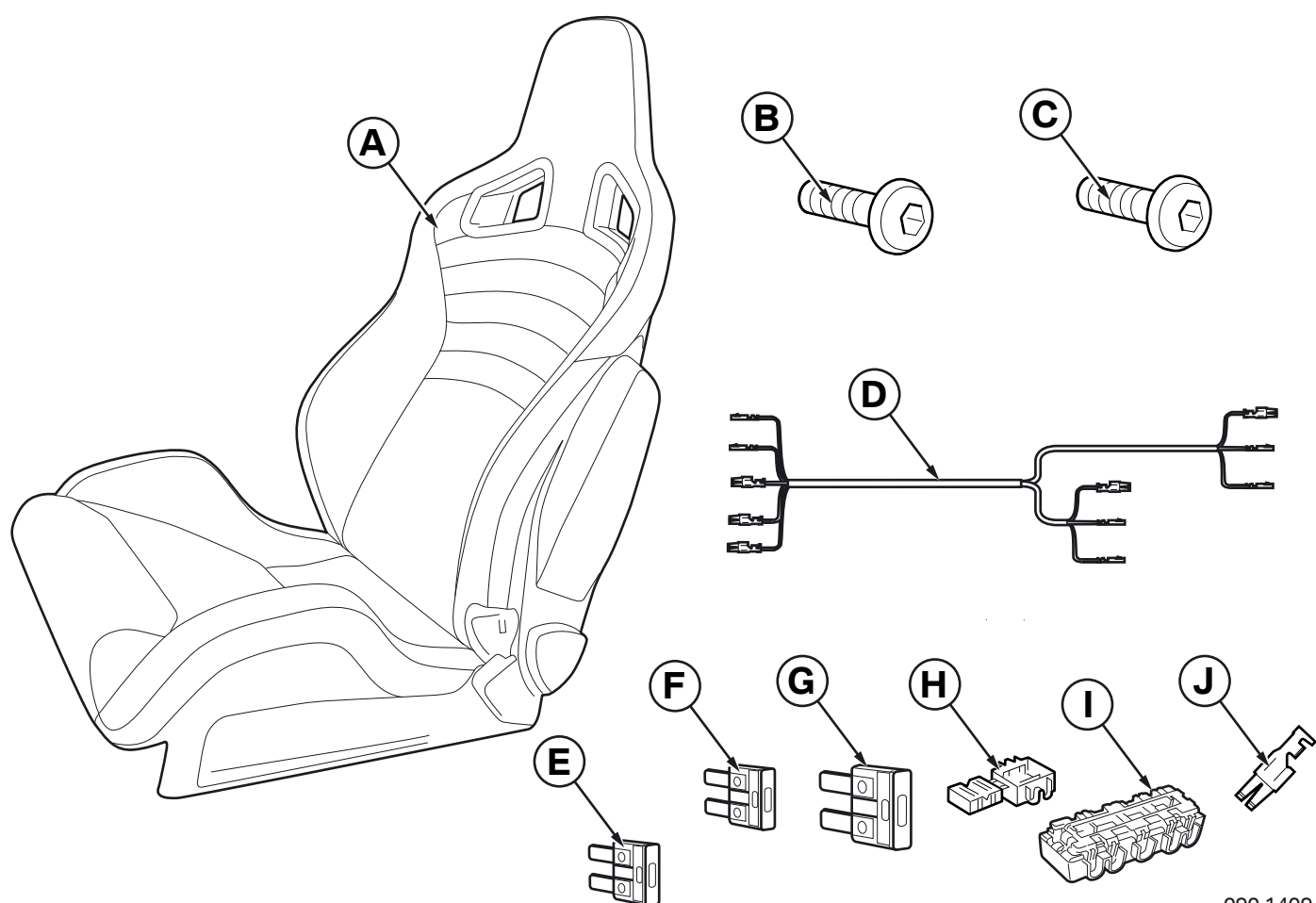

090 1409 Z

Legend

- A** BMW Performance sport seat
- B** Allen screw M8 x 16 mm (4x, not supplied in the retrofit kit)
- C** Allen screw (4x, not supplied in the retrofit kit)
- D** Retrofit cable (cars with electric or partially electric seat only, not part of the retrofit kit)
- E** Fusible link 5A mini (cars with electric or partially electric seat only, part of the retrofit cable **D**)
- F** Fusible link 20A mini (2x, cars with electric or partially electric seat only, part of the retrofit cable **D**)
- G** Fusible link 20A (2x, cars with electric or partially electric seat only, part of the retrofit cable **D**)
- H** Miniature connector 2-way (2x, cars with electric or partially electric seat only, part of the retrofit cable **D**)
- I** Miniature connector 5-way (cars with electric or partially electric seat only, part of the retrofit cable **D**)
- J** Socket contact (2x, cars with electric or partially electric seat only, part of the retrofit cable **D**)

2. Preparatory work

	ISTA No.
Conduct a brief test	---
Disconnect the negative pole of the battery	12 00 ...
The following components must be removed first	
Headrest	52 13 390
Front seat, left and right	52 13 000
In addition in cars with electric or partially electric seat	
Glovebox with casing	51 16 366
Trim at the bottom right of the dashboard	51 45 181
Undo power distributor FR	---
Trim for door pillar at the bottom right	51 43 150
Door sill strip, front interior right	51 47 000
A pillar trim at the bottom right	51 43 075
Undo centre console	---

3. Connection diagram (cars with electric or partially electric seat only)

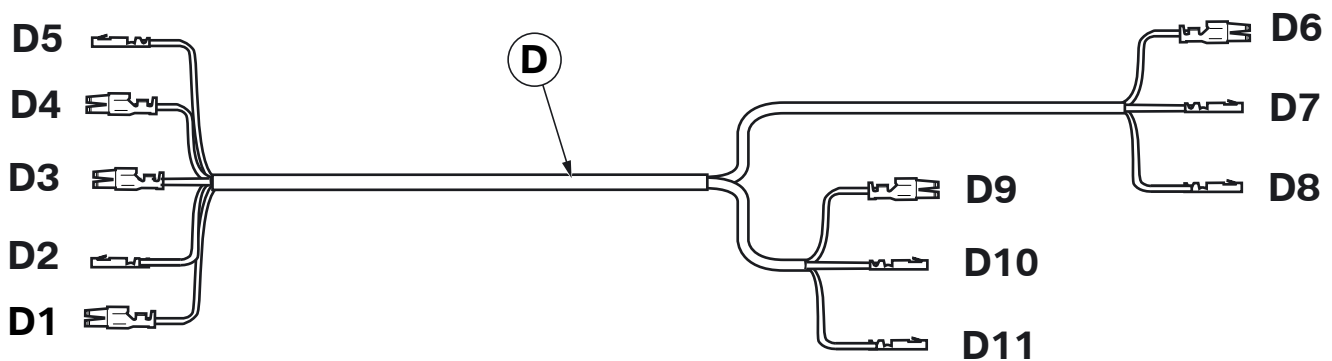

090 1408 Z

Item	Designation	Signal	Cable colour/ cross-section	Connection location in the car	Abbreviation/ slot
D	Retrofit cable	---	---	---	---
D1	Socket contact	Terminal 30	RT/WS 2.5 mm ²	Cars built after 03/07 only On power distributor FR Cars built before 03/07 only On power distributor FR	X11008 PIN 4 X11006 PIN 2
D2	Socket contact	O_SHFA	BL/VI 0.35 mm ²	To JBBF	X14270 PIN 34
D3	Socket contact	Terminal 15	GN/BR 0.35 mm ²	Cars built after 03/07 only On power distributor FR Cars built before 03/07 only On power distributor FR	X11001 PIN 10 X11003 PIN 9
D4	Socket contact	Terminal 30	RT/VI 2.5 mm ²	Cars built after 03/07 only On power distributor FR Cars built before 03/07 only On power distributor FR	X11001 PIN 3 X11006 PIN 1
D5	Socket contact	O_SHBF	BL/WS 0.35 mm ²	To JBBF	X14270 PIN 38
D6	Socket contact	Terminal 30	RT/WS 2.5 mm ²	On seat isolator plug driver's side	X275 PIN 9
D7	Socket contact	O_SHFA	BL/VI 0.35 mm ²	On seat isolator plug driver's side	X275 PIN 1
D8	Socket contact	Terminal 15	GN/BR 0.35 mm ²	On seat isolator plug driver's side	X275 PIN 5
D9	Socket contact	Terminal 30	RT/VI 2.5 mm ²	On seat isolator plug passenger side	X279 PIN 9
D10	Socket contact	O_SHBF	BL/WS 0.35 mm ²	On seat isolator plug passenger side	X279 PIN 1
D11	Socket contact	Terminal 15	GN/BR 0.35 mm ²	On seat isolator plug passenger side	X279 PIN 5

4. Installation and cabling diagram (cars with electric or partially electric seat only)

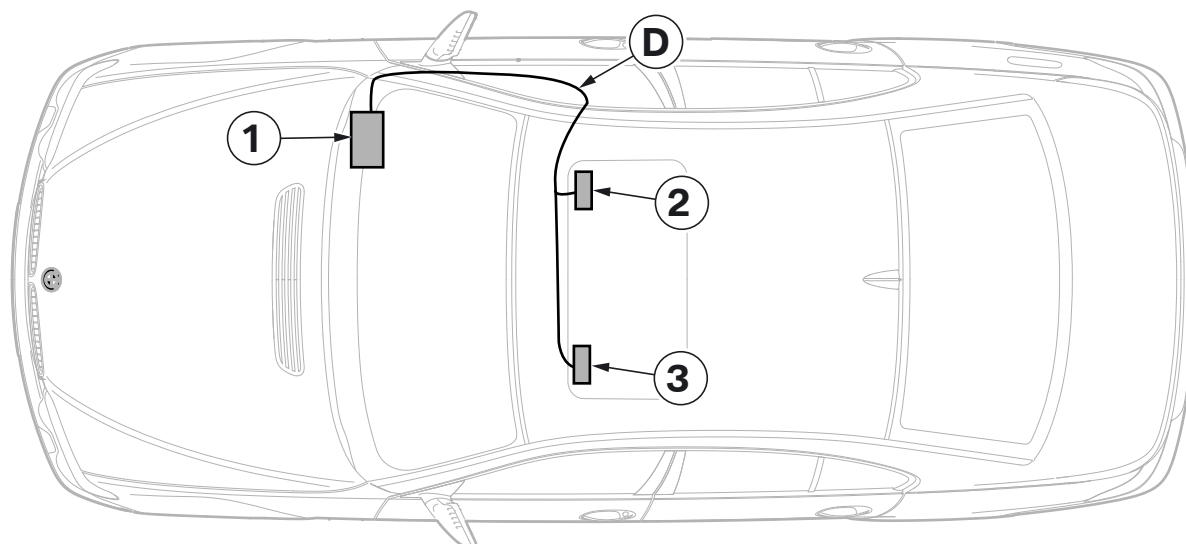

090 1410 Z

Legend

- D** Retrofit cable
- 1** Power distributor FR/JBBF
- 2** Seat isolator plug **X279**
- 3** Seat isolator plug **X275**

5. To install and connect the retrofit cable (cars with electric or partially electric seat only)

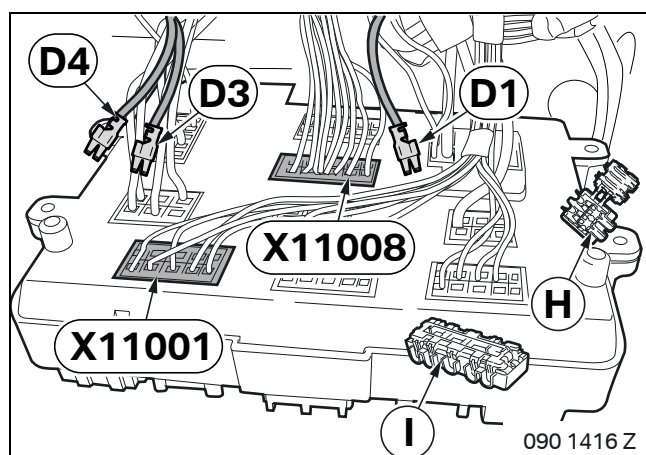

Cars built after 03/07 only

▶ If a pin chamber is already occupied, connect the corresponding branch using miniature connector **H/I** (note cable cross-sections). ◀

Route branches **D1**, **D3** and **D4** to the power distributor FR. Connect branch **D1**, RT/WS cable, to PIN 4 of plug **X11008**. Connect branch **D3**, GN/BR cable, to PIN 10 of plug **X11001**. Connect branch **D4**, RT/VI cable, to PIN 3 of plug **X11001**.

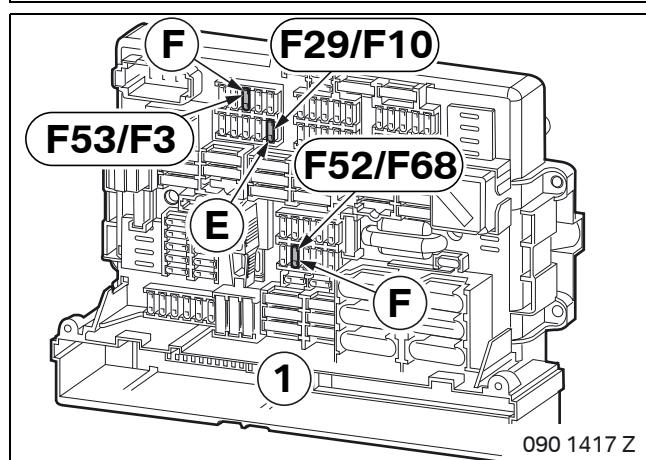

Insert fusible links **E/F** into power distributor FR (1) as follows (if not yet present):

- Fusible link **E** (5A) in slot **F29** (cars from 03/07 to 09/07) in slot **F10** (car after 09/07)
- Fusible links **F** (20A) in slots **F52** and **F53** (cars from 03/07 to 09/07) or in slots **F68** and **F3** (cars after 09/07)

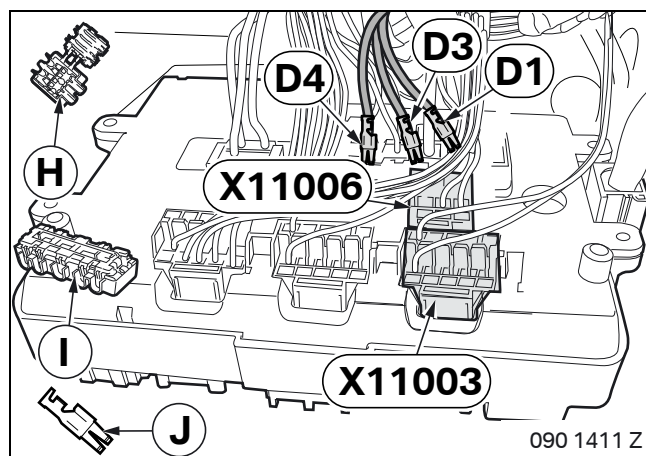

Cars built before 03/07 only

▶ If a pin chamber is already occupied, connect the corresponding branch using miniature connector **H/I** (note cable cross-sections). ◀

Route branches **D1**, **D3** and **D4** to the power distributor FR. Disconnect contacts from branch **D1** and **D4** and crimp on socket contacts **J**.

Connect branch **D1**, RT/WS cable, to PIN 2 of plug **X11006**. Connect branch **D4**, RT/VI cable, to PIN 1 of plug **X11006**. Connect branch **D3**, GN/BR cable, to PIN 9 of plug **X11003**.

5. To install and connect the retrofit cable (cars with electric or partially electric seat only)

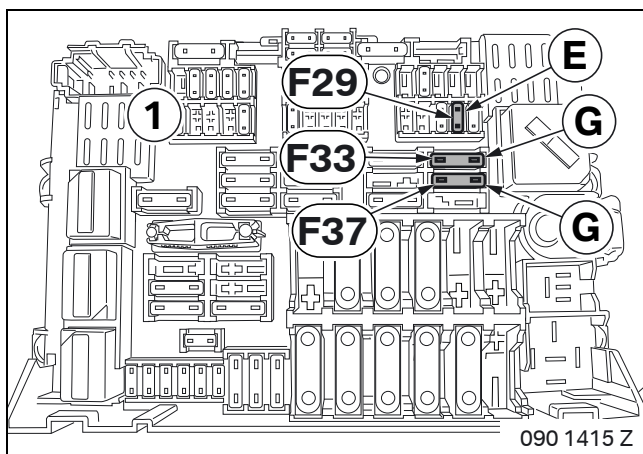

Insert fusible links **E/G** into power distributor FR (1) as follows (if not yet present):

- Insert fusible link **E** (5 A) into slot **F29**
- Fusible links **G** (20A) in slots **F33** and **F37**

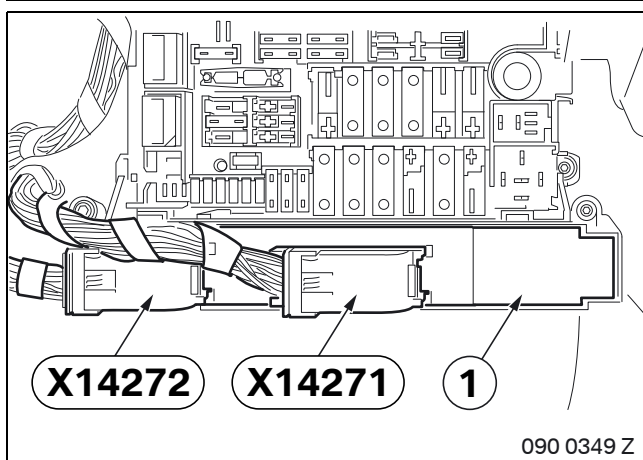

All cars

Disconnect plugs **X14271** and **X14272** and remove JBBF (1).

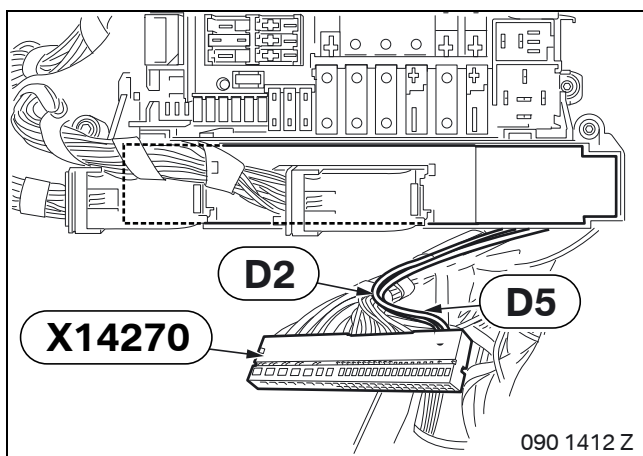

Connect branch **D2**, BLVI cable, to plug **X14270** PIN 34.
Connect branch **D5**, BLWS cable, to plug **X14270** PIN 38.
Install JBBF and power distributor VR (1).

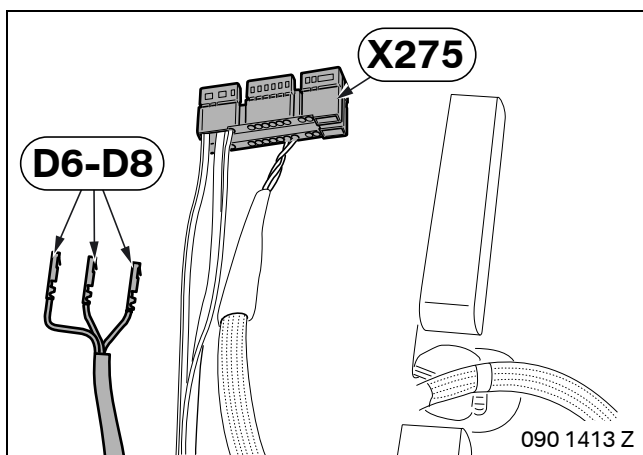

Route branches **D9-D11** to the seat isolator plug on the passenger side.

Route branches **D6-D8** under the centre console to the seat isolator plug on the driver's side.

Connect branches **D6-D8** as follows to the seat isolator plug on the driver's side, GE 19-pin socket casing **X275**:

- Branch **D6**, RT/WS cable, to PIN 9
- Branch **D7**, BLVI cable, to PIN 1
- Branch **D8**, GN/BR cable, to PIN 5

**5. To install and connect the retrofit cable
(cars with electric or partially electric seat only)**

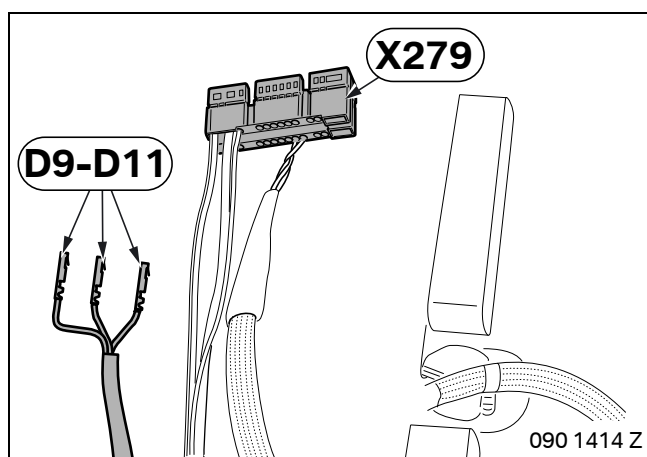

Connect branches **D9-D11** as follows to the seat isolator plug on the passenger side, GE 19-pin socket casing **X279**:

- Branch **D9**, RT/VI cable, to PIN 9
- Branch **D10**, BL/WS cable, to PIN 1
- Branch **D11**, GN/BR cable, to PIN 5

6. To install the BMW Performance sport seat

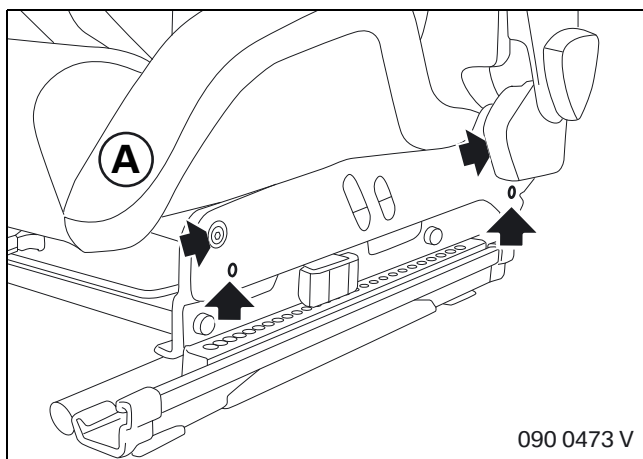

▶ BMW Performance sport seat **A** can be installed at a height to suit the individual customer using the holes (arrows).

For information about this, see the "To change the height setting of the BMW Performance sport seat" chapter.

Talk to the customer before installation. ◀

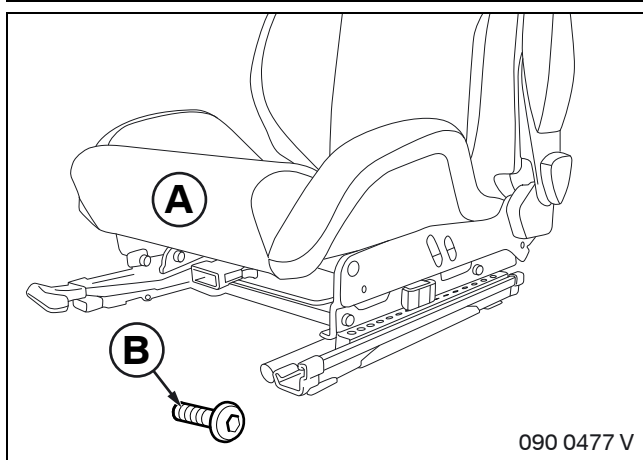

⚠ Allen screws **B** are micro-encapsulated. They are only allowed to be used once. ◀

Install BMW Performance sport seat **A** in the car using Allen screws **B**, tightening to the specified tightening torque acc. to ISTA no. 52 13 000.

7. To change the height setting of the BMW Performance sport seat

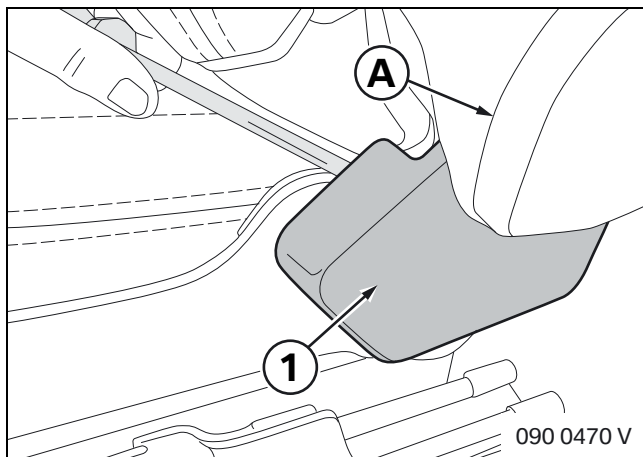

Remove cover cap (1) from sport seat **A** using a suitable tool.

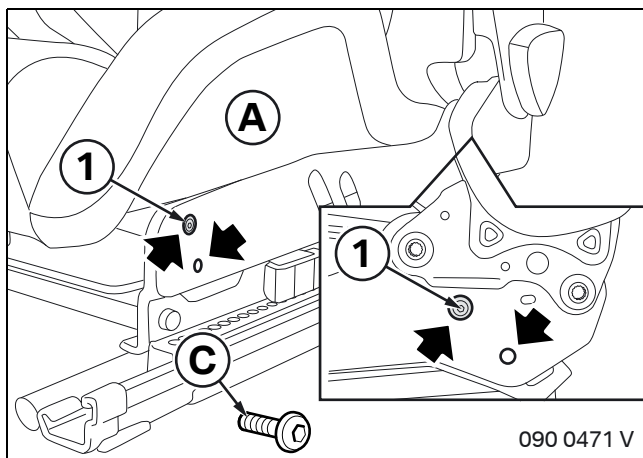

! Allen screws **C** are micro-encapsulated. They are only allowed to be used once. ◀

BMW Performance sport seat **A** can be installed at a height to suit the individual customer using the holes (arrows) and the pre-installed screws (1).

Undo screws (1) and replace them by screws **C**. Screw screws **C** into the corresponding holes (arrows).

! The tightening torque is 24 ± 2 Nm. ◀

Seal the remaining holes with the supplied plugs.

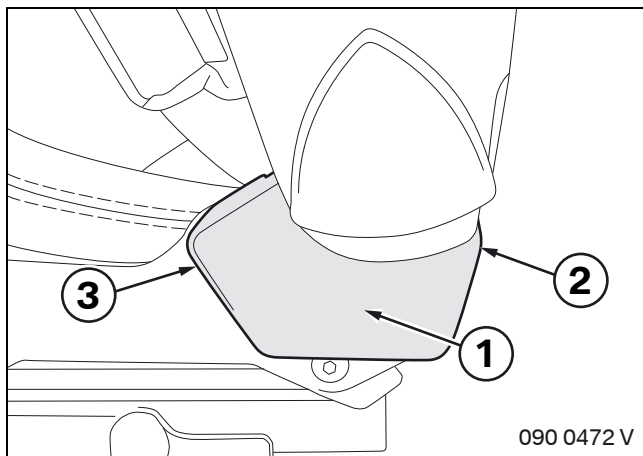

Finally, clip in the cover cap (1) first at the rear end (2) and then at the front end (3).

8. Concluding work and coding

Installing the driver's seat (ISTA no. 62 13 000)

This retrofit system requires coding:

- For cars in which the BMW Performance sport seat has been installed on the passenger side
- For E92 cars, both for the driver's seat and also for the front passenger seat
- For cars with electric or partially electric seat

- Connect the battery
- Encode the retrofit with SSS (software service station) via the **CIP** path
- Conduct a brief test
- Function test
- Re-assemble the car

9. Connection diagram (cars with electric or partially electric seat after 03/07 only)

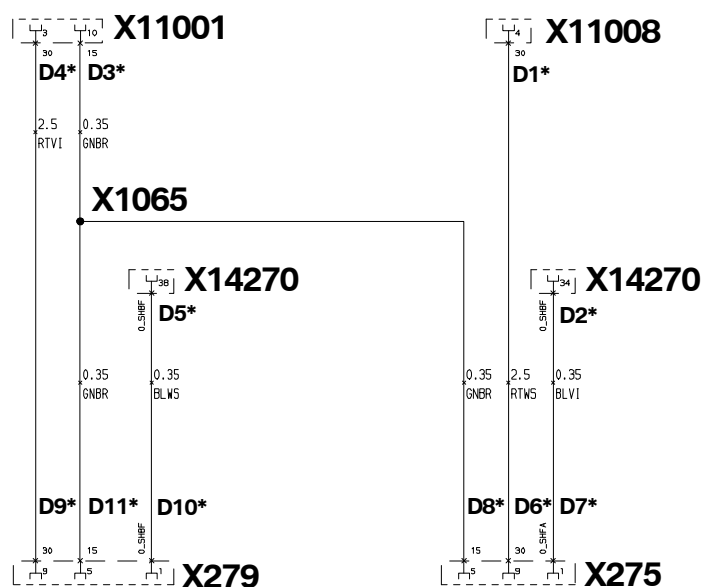

090 1418 Z

Legend

- D1*** Socket contact, in plug **X11008** (GN 10-pin socket casing)
- D2*** Socket contact, in plug **X14270** (SW 47-pin socket casing)
- D3*** Socket contact, in plug **X11001** (BL 10-pin socket casing)
- D4*** Socket contact, in plug **X11001** (BL 10-pin socket casing)
- D5*** Socket contact, in plug **X14270** (SW 47-pin socket casing)
- D6*** Socket contact, in plug **X275** (GE 19-pin socket casing)
- D7*** Socket contact, in plug **X275** (GE 19-pin socket casing)
- D8*** Socket contact, in plug **X275** (GE 19-pin socket casing)
- D9*** Socket contact, in plug **X279** (GE 19-pin socket casing)
- D10*** Socket contact, in plug **X279** (GE 19-pin socket casing)
- D11*** Socket contact, in plug **X279** (GE 19-pin socket casing)
- X1065** Terminal 15 connector

All the designations marked with an asterisk (*) apply only to these installation instructions or this circuit diagram.

Cable colours

BL	Blue	SW	Black
BR	Brown	VI	Violet
GN	Green	WS	White
RT	Red		

10. Connection diagram (cars with electric or partially electric seat before 03/07 only)

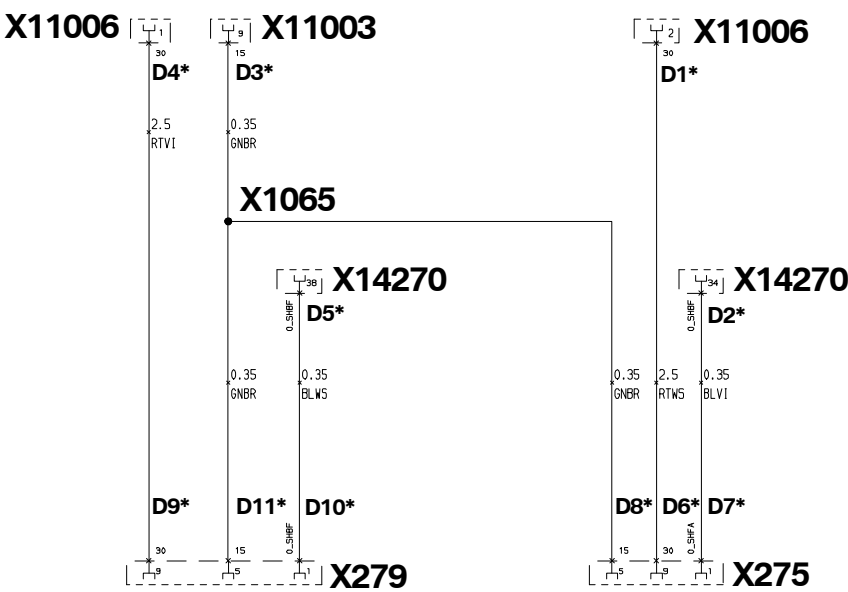

090 1419 Z

Legend

- D1*** Socket contact, in plug **X11006** (BL 6-pin socket casing)
- D2*** Socket contact, in plug **X14270** (SW 47-pin socket casing)
- D3*** Socket contact, in plug **X11003** (SW 10-pin socket casing)
- D4*** Socket contact, in plug **X11006** (BL 6-pin socket casing)
- D5*** Socket contact, in plug **X14270** (SW 47-pin socket casing)
- D6*** Socket contact, in plug **X275** (GE 19-pin socket casing)
- D7*** Socket contact, in plug **X275** (GE 19-pin socket casing)
- D8*** Socket contact, in plug **X275** (GE 19-pin socket casing)
- D9*** Socket contact, in plug **X279** (GE 19-pin socket casing)
- D10*** Socket contact, in plug **X279** (GE 19-pin socket casing)
- D11*** Socket contact, in plug **X279** (GE 19-pin socket casing)
- X1065** Terminal 15 connector

All the designations marked with an asterisk (*) apply only to these installation instructions or this circuit diagram.

Cable colours

BL	Blue	SW	Black
BR	Brown	VI	Violet
GN	Green	WS	White
RT	Red		

11. Customer information

 Keep this customer information in the car. ◀

 Subsequent installation of BMW Performance sport seats does not invalidate the owner's manual.
The BMW Performance sport seat is included in the European type approval for the car. There is no need for the installation to be approved by a technical monitoring organisation or for an entry to be made in the registration document. ◀

Notes

 Retrofitting the BMW Performance sport seat deactivates the function of the seat belt reminder for the front passenger seat. In addition, the belt hand-over is deactivated in the E92.

The driver must make sure that the front-seat passenger has fastened his or her seat belt before setting off. The function of the passenger airbag is unaffected by the seat belt reminder having been switched off. Inform the buyer of this if the car is sold. ◀

 In order to restore the original front passenger seats (in E92: driver's and front passenger seat), the seat occupancy detection of the front passenger seat and, if appropriate, the belt hand-over must be coded. Contact your BMW Service company for this. ◀

 In the BMW Performance sport seat with Easy-Entry system, the seat front/back adjustment of the BMW Performance sport seat can only be accomplished by operating the backrest lever. If the lever is not operated, the BMW Performance sport seat remains locked in its current front/back position. ◀

Seat position

The BMW Performance sport seat can be installed in 2 different height positions.

 Recommendation: For a driver and front passenger with a height of about 1.70 m, install the BMW Performance sport seat in the lower position. ◀

 The BMW Performance sport seat is a safety-relevant component of your car and must be screwed on to a specified torque value.

If you wish to have the seat height changed, have this work performed by your BMW Service company. ◀